



WALLDOC®

WallDoc® is a telemedicine solution designed for areas with space limitations. WallDoc mounts flat on the wall and occupies the same amount of space as a flat panel monitor, yet provides the functionality of a fully-integrated telemedicine solution. From a small clinic, corporate health center, or school nurse's office to an oil rig, WallDoc is the comprehensive, stationary telemedicine platform for those with space challenges.

Efficient and Intelligent

- Simple to launch and use
- Customizable to your workflow
- Integrated software and hardware

Secure and Compliant

- Integrated security features
- Prevents unauthorized usage

Sleek and Mobile

- Sleek, ergonomic design
- Adjusts to standing or seated positions
- Securely stores connected medical devices and exam cameras
- eNcounter® Software customizable to your brand

+1 (480) 922-0044
globalmed.com

15023 N 73rd Street
Scottsdale, AZ 85260
United States





WALLDOC®

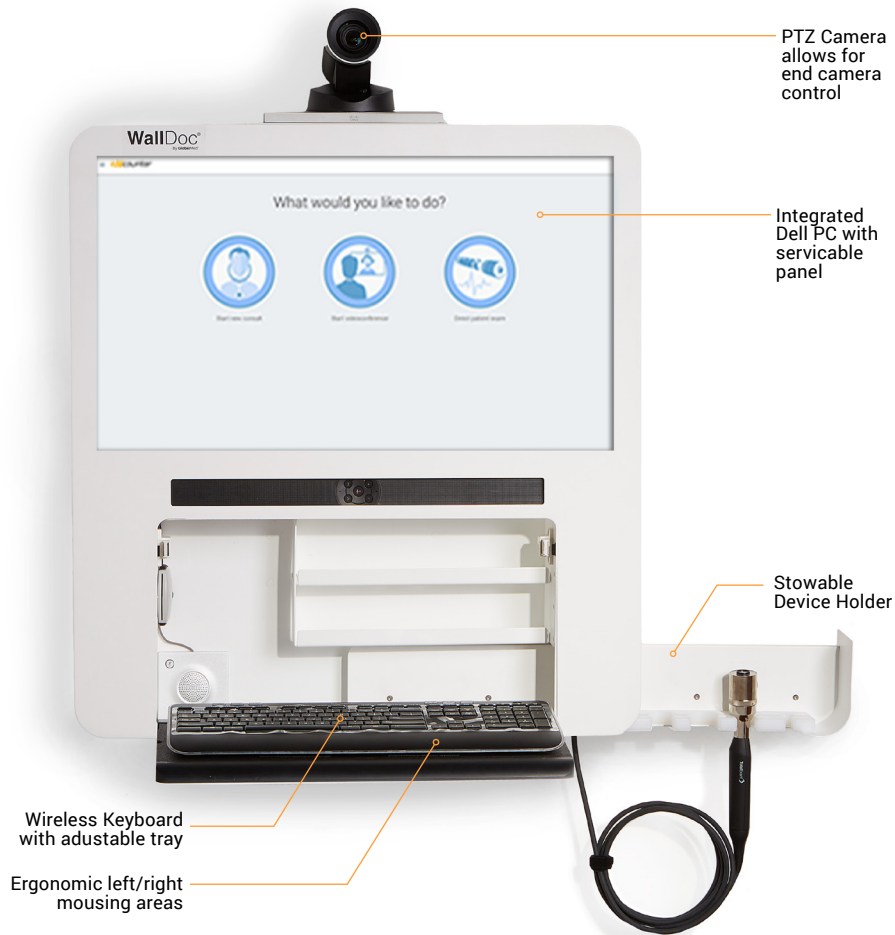

Dimensions	26" H, 26" W, 16" D minimum 32" H, 38" W, 22" D maximum with main camera, slide out device compartment and fully extended keyboard tray
Computer	Integrated Dell® computer or similar
Operating System	Windows® 7 or higher
Display	27" 1080p integrated monitor
Surface	Aluminum casing
Keyboard	Wireless full-size keyboard and mouse
Compartments	Secure integrated device storage, Security power lock and Slide out device compartment tray
Ports	Qty 8 external USB 3.0 ports
Audio	Integrated Speaker
Video Conferencing	Supports hardware and software video conferencing. Inquire with the GlobalMed sales team to learn more.
Camera	PTZ camera, standard 12x optical zoom
Movement	Vertical: 29.5" - 42" Standing height Extension: 22" max from wall
Devices	Compatible with all GlobalMed approved medical devices Qty 8 external USB 3.0 ports